

CROSS SECTION (N+F.OFA)

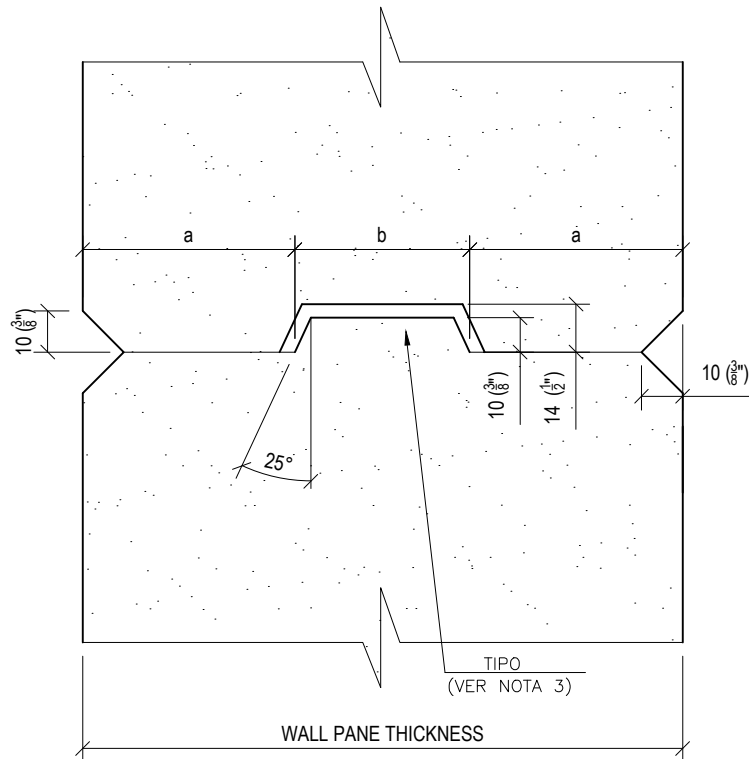

DIMENSIONS		
PANEL THICKNESS	a	b
150 (6")	49.5 (2")	51.0 (2")
175 (7")	62.0 (2 1/2")	51.0 (2")
200 (8")	74.5 (2 7/8")	51.0 (2")
250 (10")	87.0 (3 3/8")	76.0 (3")
300 (12")	99.5 (3 7/8")	101.0 (4")

NOTES

- 1.-NOT SCALE
- 2.-DIMENSIONS MILIMETERS (IN)
- 3.-WALL PANELS WITH THICKNESS LESS THAN 6"
ARE NOT PRODUCED WITH TONGUE-GROOVE PROFILE

LITECRETE, S.A. DE C.V.

Río Amacuzac #1201 Ote. ■ Col. Valle Oriente ■ San Pedro Garza García, N.L. ■ México ■ 66269

Tel. +52 (81)8399-2464 +52 (81)8399-2462 Fax +52 (81)8399-2420

www.hebel.mx

August 2020